

Soils Map

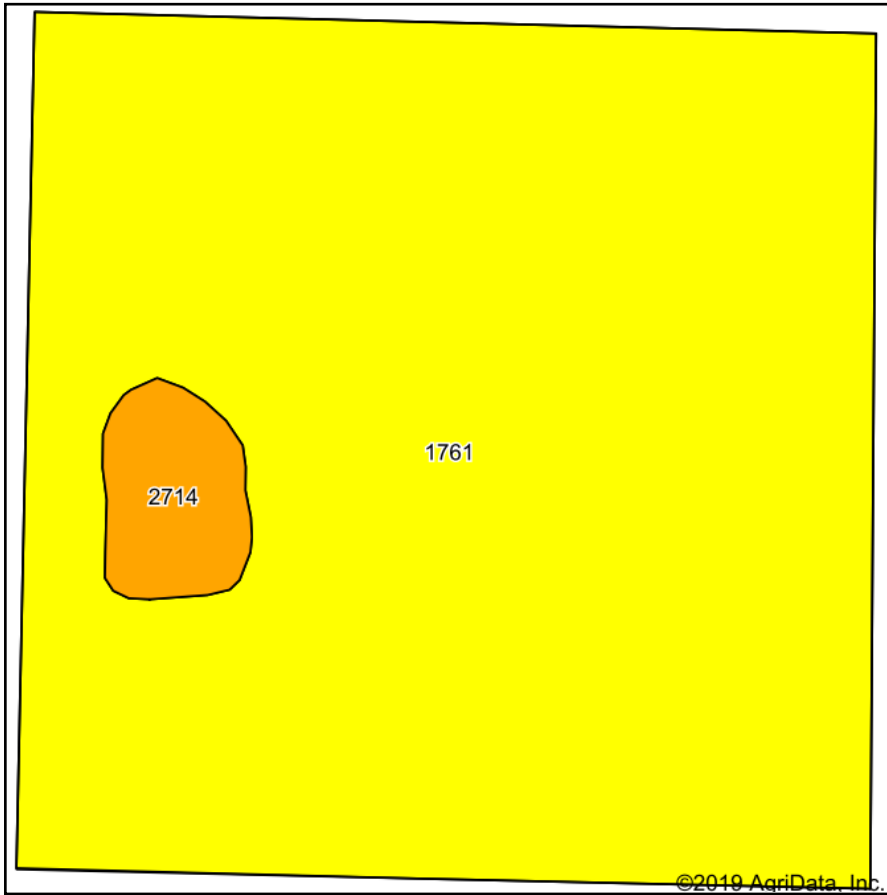

Soils data provided by USDA and NRCS.

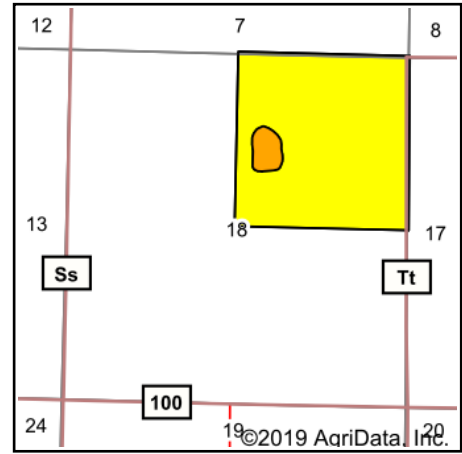

State: **Kansas**
 County: **Haskell**
 Location: **18-28S-31W**
 Township: **Lockport**
 Acres: **157.12**
 Date: **10/24/2019**



Maps Provided By:



© AgriData, Inc. 2019

www.AgriDataInc.com



Area Symbol: KS081. Soil Area Version: 16							
Code	Soil Description	Acres	Percent of field	NCCPI Overall Legend	Non-Irr Class *c	Irr Class *c	*n NCCPI Overall
1761	Richfield silt loam, 0 to 1 percent slopes	151.18	96.2%		IIIc	I	59
2714	Ness clay	5.94	3.8%		VIw		13
Weighted Average							*n 57.3

*n: The aggregation method is "Weighted Average using major components"

*c: Using Capabilities Class Dominant Condition Aggregation Method

Soils data provided by USDA and NRCS.